

Specifications

General

Power supply	: 12 V DC (11 - 16 V DC), negative ground
Current consumption	: Less than 2.2 A (CD mode; 0.5 W 4 channels)
Maximum power output	: 50 W x 4 (at 1 kHz), volume control maximum (for CQ-C1121/C1101U) : 45 W x 4 (at 1 kHz), volume control maximum (for CQ-C1001U) : Bass: ±12 dB at 100 Hz, Treble: ±12 dB at 10 kHz
Tone adjustment range	: -4 - 8 Ω
Suitable speaker impedance	: 2.5 V (CD mode, 1 kHz, 0 dB)
Pre-amp output voltage	: 200 Ω
Output impedance	: 178 x 50 x 160 mm (7 x 1 15/16 x 6 5/16")
Dimensions (W x H x D)	: 1.3 kg (2 lbs., 14 oz)
Weight	

Disc Player

Sampling frequency	: 8 times oversampling
DA converter	: 1 bit DAC System
Pick-up type	: Astigma 3-beam
Light source	: Semiconductor laser
Wave length	: 790 nm
Frequency response	: 20 Hz - 20 kHz (±1 dB)
Signal to noise ratio	: 96 dB
Total harmonic distortion	: < 0.01 % (1 kHz)
Wow and flutter	: Below measurable limits
Channel separation	: 75 dB

FM Stereo Radio

Frequency range	: 87.9 MHz-107.9 MHz
Usable sensitivity	: 11.0 dBf. (75 Ω)
50 dB quieting sensitivity	: 15.2 dBf. (75 Ω)
Frequency response	: 30 Hz-15 kHz (±3 dB)
Alternate channel selectivity	: 75 dB
Stereo separation	: 35 dB (1 kHz)
Image response ratio	: 75 dB
IF response ratio	: 100 dB
Signal/noise ratio	: 62 dB

AM Radio

Frequency range	: 530 kHz - 1 710 kHz
Usable sensitivity	: 28 dB/μV (S/N 20 dB)

Above specifications comply with EIA standards.

Power Output:	14 W RMS x 4 Channels at 4 Ω and ≤ 1% THD+N (for CQ-C1121/C1101U)
	13 W RMS x 4 Channels at 4 Ω and ≤ 1% THD+N (for CQ-C1001U)
	Signal to Noise Ratio: 85 dBA (reference: 1 W into 4 Ω)

Note:

- Specifications and design are subject to modification without notice due to improvements.
- Some figures and illustrations in this manual may be different from your product.



Accessories

	Operating Instructions (English: YFM284C441ZA) (Français: YFM284C442ZA) (Español: YFM284C443ZA)		Remote Control Unit (include a battery, only for CQ-C1121U) (EUR7641020)		Mounting Collar (FX0214C384ZA)
	Installation Instructions (YFM284C444ZA)		Lock Cancel Plate (FX0214C385ZA)		Trim Plate (YFC054C080ZA: CQ-C1121/1101U) (YFC054C058ZA: CQ-C1001U)
	Owners Information Card		Mounting Bolt (YEJV014C0020N)		Power Connector (YEAJ02877)
			Rubber Bushing (YES014C095ZA)		

- Notes:**
- The number in parentheses underneath each accessory part name is the part number for maintenance and service.
 - Accessories and their part numbers are subject to modification without prior notice due to improvements.
 - Mounting Collar and Trim Plate are mounted on the main unit at shipment.

Panasonic Consumer Electronics Company, Division of Matsushita Electric Corporation of America One Panasonic Way, Secaucus, New Jersey 07094 http://www.panasonic.com	Panasonic Sales Company, Division of Matsushita Electric of Puerto Rico, Inc. ("PSC") Ave. 65 de Infantería, Km. 9.5 San Gabriel Industrial Park, Carolina, Puerto Rico 00985 http://www.panasonic.com	Panasonic Canada Inc. 5770 Ambler Drive, Mississauga, Ontario L4W 2T3 http://www.panasonic.ca
--	---	--

YFM284C441ZB TAMACO0904-1015 Printed in China

Panasonic®

CD Player/Receiver

CQ-C1121U/C1101U/C1001U

Operating Instructions



(CQ-C1121U)



• Please read these instructions (including "Limited Warranty" and "Customer Services Directory") carefully before using this product and keep this manual for future reference.

Before Reading These Instructions

Panasonic welcomes you to our constantly growing family of electronic products owners.

We endeavor to give you the advantages of precise electronic and mechanical engineering, manufactured with carefully selected components, and assembled by people who are proud of the reputation their work has built for our company. We know this product will bring you many hours of enjoyment, and after you discover the quality, value and reliability we have built into it, you too will be proud to be a member of our family.

This operating instruction manual is for 3 models CQ-C1121U, CQ-C1101U and CQ-C1001U. All illustrations throughout this manual represent model CQ-C1121U unless otherwise specified. The following table describes the differences among 3 models.

Features	Models	CQ-C1121U	CQ-C1101U	CQ-C1001U
Volume control		Rotary knob	Rotary knob	Button
Remote control function		Yes (Included)	No	No
Pre-amp. output connector		Rear/Front	Rear	Rear

Differences Among 3 Models

U.S.A.

Obtain Product Information and Operating Assistance; locate your nearest Dealer or Servicenter; purchase Parts and Accessories; or make Customer Service and Literature requests by visiting our Web site at: <http://www.panasonic.com/support> or, contact us via the web at: <http://www.panasonic.com/contactinfo>

You may also contact us directly at:
1-800-211-PANA (7262),
Monday-Friday 9 am-9 pm; Saturday-Sunday 10 am-7 pm, EST.

For hearing or speech impaired TTY users, TTY : 1-877-833-8855

Accessory Purchases:
Purchase Parts, Accessories and Instruction Books online for all Panasonic Products by visiting our Web Site at: <http://www.pasc.panasonic.com> or, send your request by E-mail to: npccparts@panasonic.com

You may also contact us directly at:
1-800-332-5368 (Phone) 1-800-237-9080 (Fax Only) (Monday-Friday 9 am to 8 pm, EST.)
Panasonic Services Company
20421 84th Avenue South, Kent, WA 98032
(We accept Visa, MasterCard, Discover Card, American Express, and Personal Checks)

For hearing or speech impaired TTY users, TTY : 1-866-605-1277

Service in Puerto Rico
Matsushita Electric of Puerto Rico, Inc.
Panasonic Sales Company
Factory Servicer:
Ave. 65 de Infantería, Km. 9.5, San Gabriel Industrial Park, Carolina, Puerto Rico 00985
Phone (787) 750-4300, Fax (787) 768-2910

CANADA

WARRANTY SERVICE
For product operation and information assistance, please contact your Dealer or our Customer Care Centre at: Telephone #: (905) 624-5505 Fax #: (905) 238-2360
Web: www.panasonic.ca
For product repairs, please contact one of the following:
• Your Dealer who will inform you of an authorized Servicentre nearest you.
• Our Customer Care Centre at (905) 624-5505 or www.panasonic.ca
• A Panasonic Factory Servicentre listed below.

Richmond, British Columbia
Panasonic Canada Inc.
12111 Riverside Way
Richmond, BC V6W 1K8
Tel: (604) 278-4211
Fax: (604) 278-5627

Mississauga, Ontario
Panasonic Canada Inc.
5770 Ambler Dr.
Mississauga, ON L4W 2T3
Tel: (905) 624-8447
Fax: (905) 238-2418

Calgary, Alberta
Panasonic Canada Inc.
6835-8th St. N. E. Calgary, AB T2E 7H7
Tel: (403) 295-3955
Fax: (403) 274-5493

Lachine, Quebec
Panasonic Canada Inc.
3075, rue Louis A. Amos
Lachine, QC H8T 1C4
Tel: (514) 633-8684
Fax: (514) 633-8020

Customer Services Directory

Preparation

Battery Installation

Pull the insulation film out from the backside of the remote control gently.

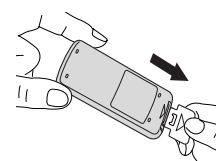

Note: Battery Information:
Battery Type: Panasonic lithium battery (CR2025) (Included in the remote control)
Battery Life: Approximately 6 months under normal use (at room temperature)

The 12-hour system is used for the clock.

1 Turn the ignition switch until the accessory indicator lights.

2 Press [SRC] (PWR: Power).

3 Press [DISP] (CLOCK).



4 Hold down [DISP] (CLOCK) for more than 2 seconds.



5 Adjust the hour.



[>]: sets the hour ahead.

[<]: sets the hour back.

6 Press [DISP] (CLOCK).



7 Adjust the minute.



[>]: sets the minute ahead.

[<]: sets the minute back.

8 Press [DISP] (CLOCK).



- Notes:**
- *AdJ is displayed before adjusting the clock.
 - Hold down [<] or [>] to change numbers rapidly.

Clock Setting

Clock Display at Power Off

Press [DISP] (Display) to change the display.

Display off



Maintenance

Cleaning the Unit

Your product is designed and manufactured to ensure the minimum of maintenance. Use a soft cloth for routine exterior cleaning. Never use benzine, thinner, or other solvents.

Fuse

If the replaced fuse fails, contact your nearest authorized Panasonic Servicenter.

Warning

- Use fuses of the same specified rating (15 A). Using substitutes or fuses with higher ratings, or connecting the unit directly without a fuse could cause fire or damage to the unit. If the replaced fuse fails, contact your nearest authorized Panasonic Servicenter.

Anti-Theft System

This unit is equipped with a removable face plate. Removing this face plate makes the unit totally inoperable.

Removing/Mounting (Anti-Theft System)

Caution

- This face plate is not waterproof. Do not expose it to water or excessive moisture.
- If dirt or other foreign substances get on the contacts, wipe them off with a clean and dry cloth.
- Do not touch the contacts on the face plate and the main unit, since this may result in poor electrical contact.
- If dirt or other foreign substances get on the contacts, wipe them off with a clean and dry cloth.

Removing

- Turn off the power.
- Press [**▲**]. The face plate will open.
- Pull it out toward you.

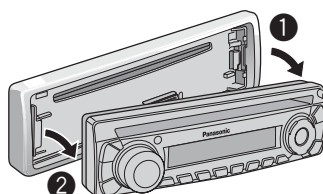

Mounting

- Slide the left side of the face plate in place.
- Press the right end of the face plate until a "click" is heard.

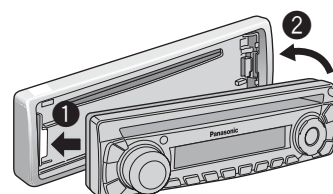

Safety Information

Read the operating instructions for the unit and all other components of your car audio system carefully before using the system. They contain instructions about how to use the system in a safe and effective manner. Panasonic assumes no responsibility for any problems resulting from failure to observe the instructions given in this manual.

Warning

This pictograph intends to alert you to the presence of important operating instructions and installation instructions. Failure to heed the instructions may result in severe injury or death.

Caution

This pictograph intends to alert you to the presence of important operating instructions and installation instructions. Failure to heed the instructions may result in injury or material damage.

Warning

Observe the following warnings when using this unit.

- The driver should neither watch the display nor operate the system while driving. Watching the display or operating the system will distract the driver from looking ahead of the vehicle and can cause accidents. Always stop the vehicle in a safe location and use the parking brake before watching the display or operating the system.
- Use the proper power supply. This product is designed for operation with a negative grounded 12 V DC battery system. Never operate this product with other battery systems, especially a 24 V DC battery system.
- Keep batteries and insulation film out of reach of infants. Batteries and insulation film can be ingested, so keep them out of the reach of infants. If an infant ingests a battery or insulation film, please seek immediate medical attention.
- Protect the Deck Mechanism. Do not insert any foreign objects into the slot of this unit.
- Do not disassemble or modify the unit. If the remote control unit lies about, it could fall on the floor while driving, get wedged under the brake pedal, and lead to a traffic accident.
- Refer fuse replacement to qualified service personnel. When the fuse burns out, eliminate the cause and have it replaced with the fuse prescribed for this unit by a qualified service engineer. Incorrect replacement of the fuse may lead to smoke, fire, and damage to the product.
- Disconnect the lead from the negative (-) battery terminal before installation. Wiring and installation with the negative (-) battery terminal connected may cause electrical shock and injury due to a short circuit. Some cars equipped with the electrical safety system have specific procedures of battery terminal disconnection. FAILURE TO FOLLOW THE PROCEDURE MAY LEAD TO THE UNINTENDED ACTIVATION OF THE ELECTRICAL SAFETY SYSTEM RESULTING IN DAMAGE TO THE VEHICLE AND PERSONAL INJURY OR DEATH.
- Never use safety-related components for installation, grounding, and other such functions. Do not use safety-related vehicle components (fuel tank, brake, suspension, steering wheel, pedals, airbag, etc.) for wiring or fixing the product or its accessories.
- Installing the product on the air bag cover or in a location where it interferes with airbag operation is prohibited.
- Check for piping, gasoline tank, electric wiring, and other items before installing the product. If you need to open a hole in the vehicle chassis to attach or wire the product, first check where the wire harness, gasoline tank, and electric wiring are located. Then open the hole from outside if possible.
- Never install the product in a location where it interferes with your field of vision.
- Never have the power cord branched to supply other equipment with power.
- After installation and wiring, you should check the normal operation of other electrical equipment. The continuation of their using in abnormal conditions may cause fire, electrical shock or a traffic accident.
- In the case of installation to an airbag-equipped car, confirm warnings and cautions of the vehicle manufacturer before installation.
- Make sure the leads do not interfere with driving or getting in and out of the vehicle.
- Insulate all exposed wires to prevent short circuiting.

Limited Warranty

U.S.A.

PANASONIC CONSUMER ELECTRONICS COMPANY,
DIVISION OF MATSUSHITA ELECTRIC CORPORATION OF AMERICA
One Panasonic Way, Secaucus, New Jersey 07094

PANASONIC SALES COMPANY,
DIVISION OF MATSUSHITA ELECTRIC OF PUERTO RICO, INC.
Ave. 65 de Infantería, Km. 9.5, San Gabriel Industrial Park
Carolina, Puerto Rico 00985

PANASONIC AUTO PRODUCTS LIMITED WARRANTY

LIMITED WARRANTY COVERAGE
If your product does not work properly because of defects in materials and workmanship.
Panasonic Consumer Electronics Company or Panasonic Sales Company (collectively referred to as "the warrantor") will, for the length of the period indicated in the chart below, which starts with the date of original purchase ("warranty period"), at its option either (a) repair your product with new or refurbished parts, or (b) replace it with a new or refurbished product. The decision to repair or replace will be made by the warrantor.

Categories	Parts	Labor
Audio Components (except items listed below)	One (1) Year	One (1) Year
NKE Series Audio Components (except items listed below)	Two (2) Years	Two (2) Years
Speakers	One (1) Year	Not Applicable
Accessories (in exchange for defective items)	Ninety (90) Days	Not Applicable

During the "Labor" warranty period, there will be no charge for labor. During the "Parts" warranty period, there will be no charge for parts. You must carry in or mail in your product during the warranty period. If non-rechargeable batteries are included, they are not warranted. This warranty only applies to products purchased and serviced in the United States or Puerto Rico. This warranty is extended only to the original purchaser of a new product which was not sold "as is." A purchase receipt or other proof of the original purchase date is required for warranty service.

CARRY-IN OR MAIL-IN SERVICE
For Carry-In or Mail-In Service in the United States, call 1-800-211-PANA (7262) or visit [Panasonic Web Site](http://www.panasonic.com): <http://www.panasonic.com>
For assistance in Puerto Rico, call Panasonic Sales Company (787)-750-4300 or fax (787)-768-2910.

LIMITED WARRANTY LIMITS AND EXCLUSIONS
This warranty ONLY COVERS failures due to defects in materials and workmanship, and DOES NOT COVER normal wear and tear or cosmetic damage. The warranty ALSO DOES NOT COVER damages which are caused during shipment, failures which are caused by products not supplied by the warrantor, failures which result from accident, misuse, abuse, neglect, mishandling, misapplication, alteration, faulty installation, set-up adjustment, maladjustment of consumer control, improper maintenance, improper antenna, inadequate signal reception or pickup, power line surge, improper voltage supply, lightning, modification, commercial use (such as use in hotels, offices, restaurants, or other business uses) or rental use of the product, or service by anyone other than the technician from Factory Servicenter or other authorized service centers, or damage that is attributable to acts of God.

THERE ARE NO EXPRESS WARRANTIES EXCEPT AS LISTED UNDER "LIMITED WARRANTY COVERAGE". THE WARRANTOR IS NOT LIABLE FOR INCIDENTAL OR CONSEQUENTIAL DAMAGES RESULTING FROM THE USE OF THIS PRODUCT, OR ARISING OUT OF ANY BREACH OF THIS WARRANTY. (As examples, this excludes damages for lost time, cost of having someone remove or re-install an installed unit if applicable, travel to and from the sevice, and loss of media, data or other memory contents. The items listed are not exclusive, but are for illustration only.) ALL EXPRESS AND IMPLIED WARRANTIES, INCLUDING THE WARRANTY OF MERCHANTABILITY, ARE LIMITED TO THE PERIOD OF THE LIMITED WARRANTY.

Some states do not allow the exclusion or limitation of incidental or consequential damages, or limitations on how long an implied warranty lasts, so the exclusions may not apply to you.

This warranty gives you specific legal rights and you may also have other rights which vary from state to state. If a problem with this product develops during or after the warranty period, you may contact your dealer or Servicenter. If the problem is not handled to your satisfaction, then write to warrantor's Consumer Affairs Department at the addresses of the warrantor.

PARTS AND SERVICE WHICH ARE NOT COVERED BY THIS LIMITED WARRANTY ARE YOUR RESPONSIBILITY.

Customer's Record	
Model	No.
Serial	Serial
No.	No.
Dealer's	Dealer's
No.	No.
Code	Code
No.	No.
Dealer's	Dealer's
Address	Address
Date of	Date of
Purchase	Purchase

CANADA

Panasonic Canada Inc.
5770 Ambler Drive, Mississauga Ontario L4W 2T3

PANASONIC PRODUCT LIMITED WARRANTY

Panasonic Canada Inc. warrants this product to be free from defects in materials and workmanship and agrees to remedy any such defect for a period as stated below from the date of original purchase.

CAR AUDIO PRODUCT - ONE (1) YEAR, PARTS AND LABOUR
(The labour to install or remove the product is not warranted)

LIMITATIONS AND EXCLUSIONS
This warranty does not apply to products purchased outside Canada or to any product which has been improperly installed, subjected to usage for which the product was not designed, misused or abused, damaged during shipping, or which has been altered or repaired in any way that affects the reliability or detracts from the performance, nor does it cover any product which is used commercially. Dry cell batteries are also excluded from coverage under this warranty. This warranty is extended to the original end user purchaser only. A purchase receipt or other proof of the original purchase date is required before warranty service is performed. THIS EXPRESS, LIMITED WARRANTY IS IN LIEU OF ALL OTHER WARRANTIES, EXPRESS OR IMPLIED, INCLUDING ANY IMPLIED WARRANTIES OF MERCHANTABILITY AND FITNESS FOR A PARTICULAR PURPOSE. IN NO EVENT WILL PANASONIC CANADA INC. BE LIABLE FOR ANY SPECIAL, INDIRECT OR CONSEQUENTIAL DAMAGES. In certain instances, some jurisdictions do not allow the exclusion or limitation of incidental or consequential damages, or the exclusion of implied warranties, so the above limitations and exclusions may not be applicable.

IF YOU SHIP THE PRODUCT TO A SERVICENTER
Carefully pack and send prepaid, adequately insured and preferably in the original carton. Include details of the defect claimed, and proof of the date of original purchase.

Caution

Observe the following cautions when using this unit.

- Keep the sound volume at an appropriate level. Keep the volume level low enough to be aware of road and traffic conditions while driving.
- This unit is designed for use exclusively in automobiles.
- Do not operate the unit for a prolonged period with the engine turned off. Operating the audio system for a long period of time with the engine turned off will drain the battery.
- Do not expose the unit to direct sunlight or excessive heat. Otherwise these will raise the interior temperature of the unit, and it may lead to smoke, fire, or other damage to the unit.
- Do not use the product where it is exposed to water, moisture, or dust. Exposure of the unit to water, moisture, or dust may lead to smoke, fire, or other damage to the unit. Make especially sure that the unit does not get wet in car washes or on rainy days.

Observe the following cautions when installing.

- Refer wiring and installation to qualified service personnel. Installation of this unit requires special skills and experience. For maximum safety, have it installed by your dealer. Panasonic is not liable for any problems resulting from your own installation of the unit.
- Follow the instructions to install and wire the product. Not following the instructions to properly install and wire the product could cause an accident or fire.
- Take care not to damage the leads. When wiring, take care not to damage the leads. Prevent them from getting caught in the vehicle chassis, screws, and moving parts such as seat rails. Do not scratch, pull, bend or twist the leads. Do not run them near heat sources or place heavy objects on them. If leads must be run over sharp metal edges, protect the leads by winding them with vinyl tape or similar protection.
- Use the designated parts and tools for installation. Use the supplied or designated parts and appropriate tools to install the product. The use of parts other than those supplied or designated may result in internal damage to the unit. Faulty installation may lead to an accident, a malfunction or fire.
- Do not block the air vent or the cooling plate of the unit. Blocking these parts will cause the interior of the unit to over-heat and will result in fire or other damage.

The following applies only in the U.S.A.

Part 15 of the FCC Rules

FCC Warning:

General

CO-C1121U **CO-C1101U**
[VOL] (Volume) (Turn)

CO-C1001U
[VOLUME▲] [VOLUME▼] (Press) adjusts the volume.

CO-C1121U
Remote Control Sensor

[D•M] (Direct Memory) tunes into the station memorized in D•M. (Hold down it for more than 2 seconds to memorize the current station.)

[SRC] (Source) selects a source. **[PWR]** (Power) toggles power on/off.

[MUTE] toggles mute on/off.

[SQ] (Sound Quality) selects a sound type (SQ).

lights when mute is on.

Power On/Off

Turn your car's ignition switch to the ACC or ON position.
Power on: Press [SRC] (PWR: Power).
Power off: Hold down [SRC] (PWR: Power) for more than 1 second.

Source Selection

Press [SRC] (Source) to change the source.

Radio → Disc Player

Volume Adjustment

(Setting Range: 0 to 40, Default: 18)
CO-C1121U **CO-C1101U**
Turn [VOL] (Volume).
CO-C1001U
Press [VOLUME▲] or [VOLUME▼].

Mute

ON: Press [MUTE]. (MUTE lights.)
OFF: Press [MUTE] again.

SQ (Sound Quality)

SQ is a function that can call up various sound types at the touch of button in accordance with your listening music type. Press [SQ] to select the sound type as follows:

- FLAT** (FLAT) flat frequency response: does not emphasize any part. (Default)
- ROCK** (ROCK) speedy and heavy sound: exaggerates bass and treble.
- POP** (POP) wide-ranged and deep sound: slightly emphasizes bass and treble.
- VOCAL** (VOCAL) clear sound: emphasizes middle tone and slightly emphasizes treble.

Note: Settings of SQ, bass and treble are influenced by one another. If such an influence causes distortion to the audio signal, readjust bass/treble or volume.

Remote Control Unit (Only for C1121U)

Note: This operating instruction manual explains operations for use with the buttons on the main unit. (Different operations excluded)

[PWR] (Power) toggles power on/off.

[MODE] selects a mode (source).

[MUTE] toggles mute on/off.

[VOL▲] [VOL▼] adjust the volume.

[BAND] selects a band in the radio source, toggles pause/play in the player source. (Hold down it for more than 2 seconds.)

[TUNE<] [TUNE>] down/up the frequency. (Hold down it for more than 2 seconds for seek tuning.)
[TRACK◀] [TRACK▶] skip to the previous/next track in the player mode. (Hold down it for more than 2 seconds.)

Battery Replacement

- Remove the battery holder with the remote control unit placed on a flat surface.
 - Stick your thumbnail into the groove, and push the holder in the direction of the arrow, and at the same time.
 - Pull it out in the direction of the arrow using a tough pointed object.
- Put a battery in the case with (+) side facing up.
- Put the case back.

Warning

- Keep batteries away from children to avoid the risk of accidents. If an infant ingests a battery, please seek immediate medical attention.

Caution

- Remove and dispose of the old battery immediately.
- Do not disassemble, heat or short the battery. Do not throw the battery into a fire or water.
- Follow local regulations when disposing of the battery.
- Improper use of batteries may cause overheating, an explosion or ignition, resulting in injury or a fire.

Note: Battery Information:
Battery Type: Panasonic lithium battery (CR2025) (Included in the remote control)
Battery Life: Approximately 6 months under normal use (at room temperature)

Battery Notes

Radio (AM/FM)

[BAND] selects a band in the radio source. **(APM)** (Auto Preset Memory) executes APM in the radio source. (Hold down it for more than 2 seconds)

[D•M] (Direct Memory) tunes into the station memorized in D•M. (Hold down it for more than 2 seconds to memorize the current station.)

[DISP] (Display) switches the information on the display.

[SRC] (Source) selects a source.

Preset buttons [1] to [6] selects a preset station in the radio source, and presets the current station. (Hold down it for more than 2 seconds)

[TUNE<] [TUNE>] down/up the frequency. (Hold down it for more than 2 seconds for seek tuning.)

Operation Flow

- Press [SRC] (Source) to select the radio source.
- Press [BAND] to select a band.
- Select a station.

Frequency adjustment

[TUNE<]: Lower
[TUNE>]: Higher

Note: Hold down either of them for more than 0.5 seconds and release it for station search.

Preset station selection

Press the corresponding preset button from [1] to [6] to tune into a preset station.

Disc Player

Disc slot takes a disc in with the label-side facing up. **Note:** The power will be turned on automatically when a disc is loaded.

[TRACK◀] [TRACK▶] skip to the previous/next track in the player mode. Hold down either of them for fast reverse/fast forward.

[Eject] ejects the disc.

[DISP] (Display) switches the information on the display.

[SRC] (Source) selects a source

[1] to [6] (7) to (12) (Hold down one of them for more than 2 seconds.) select a track directly.

[REP] (Repeat) toggles on/off the repeat play. **(RANDOM)** toggles on/off the random play. (Hold down it for more than 2 seconds.)

(SCAN) toggles on/off the scan play. (Hold down it for more than 2 seconds.)

Caution

- Do not insert a disc when the **Disc** indicator lights.
- Refer to the section of "Notes on Discs".
- This unit does not support 8 cm (3") discs.
- If you insert an 8 cm (3") disc and cannot eject it, turn ACC of your car off once and turn it on again, then press [Eject].

This unit does not support MP3 and WMA disc playback.

- This unit does not support CD text display.
- Do not insert foreign matter into the disc slot.

Operation Flow

- Press [SRC] (Source) to select the Disc Player mode.
- Select a desired portion.

Track selection

Press [TRACK◀] or [TRACK▶].

Note: To perform fast forward/reverse, hold down either of them.

Pause

Press [BAND] (II / ▶). Press again to cancel.

Direct track selection

Press a track number button from [1] to [6].

- The corresponding track (1-6) starts playing.

Hold down a track number button from [1] to [6] ((7) to (12)) for more than 2 seconds.

- The corresponding track (7-12) starts playing.

Operation Flow

Radio Mode Display

lights while receiving an FM stereo signal.

Frequency Band Preset Number

100.7 FM 16

lights while receiving the D•M (Direct Memory) station.

Display change

Press [DISP] (Display) to change the display.

Radio mode display (Default)

100.7 FM 16

808 FM 16

Clock display

Station Preset

Up to 6 stations can be preset in AM, FM1, FM2, and FM3 respectively. Preset stations can be simply called up by pressing one of the preset buttons from [1] to [6].

Auto Preset Memory (APM)

With this operation, stations with good receiving conditions can be automatically stored in the preset memory.

- Select a band.
- Hold down [BAND] (APM) for more than 2 seconds.

The preset stations under best receiving conditions are received for 5 seconds each after presetting the stations (SCAN). To stop scanning, press one of the preset buttons from [1] to [6].

Note: New stations overwrite existing saved stations.

Direct Memory

Your favorite FM/AM radio station can be memorized in the [D•M] button and you can call back the radio station just by pressing the button whatever the current sound source is, even if the power is off.

D•M station writing

- Select a station you would like to preset.
- Hold down [D•M] for more than 2 seconds.

D•M station calling

- Press [D•M] (Direct Memory). Press again to cancel.

Player Mode Display

Random indicator

Play time

Track

Repeat indicator

lights when a disc is in the player.

007

6

1009 6

Clock display

Display change

Press [DISP] (Display) to change the display.

Player mode display (Default)

007 6

1009 6

Clock display

Random play

All the available tracks are played in a random sequence.

Hold down [REP] (RANDOM) for more than 2 seconds.

Hold down again to cancel.

Repeat play

The current track is repeated.

Press [REP] (Repeat). Press again to cancel.

Scan play

The first 10 seconds of each track is played in sequence.

Hold down [SQ] (SCAN) for more than 2 seconds.

Hold down again to cancel.

Notes on CD/CD Media

If you use commercial CDs, they must have the label shown at right. Some copy-protected music CDs are not playable.

How to hold a disc

- Do not touch the underside of a disc.
- Do not scratch on a disc.
- Do not bend a disc.
- When not in use, keep a disc in a case.

Do not use irregularly shaped discs. Do not leave discs in the following places:

- Direct sunlight
- Near car heaters
- Dirty, dusty and damp areas
- Seats and dashboards

Disc cleaning

Use a dry, soft cloth to wipe from the center outward. Do not attach any seals or labels to your discs. Do not write on the disc label with a ballpoint pen or other hard-point pens.

Notes on CD-Rs/RWs

- You may have trouble playing back some CD-RW discs recorded using CD recorders (CD-R/RW drives), either due to their recording characteristics or dirt, fingerprints, scratches, etc. on the disc surface.
- CD-RW discs are less resistant to high temperatures and high humidity than ordinary music CDs. Leaving them inside a car for extended periods may damage them and make playback impossible.
- Some CD-R/Ws cannot be played back successfully due to incompatibility among writing software, a CD recorder (CD-R/RW drive) and the discs.
- This player cannot play the CD-R/RW discs if the session is not closed.
- This player cannot play the CD-R/RW discs which contain other than CD-DA data (MP3/WMA, Video CD, etc.).
- Be sure to observe the instructions of the CD-R/RW disc for handling it.

Notes on Discs

Audio Setting

CO-C1121U **CO-C1101U**

[VOL] selects a value in the audio menu. **(PUSH SEL)** (Push to Select) selects items in the audio menu.

[DISP] (Display) exits from the audio menu.

CO-C1001U

[▲] or [▼] selects a value in the audio menu. **[SEL]** (Select) selects items in the audio menu.

- Display the audio menu. **CO-C1121U** **CO-C1101U**
Press [VOL] (PUSH SEL: Select). **CO-C1001U**
Press [SEL] (Select).
- Select a mode to be adjusted. **CO-C1121U** **CO-C1101U**
Press [VOL] (PUSH SEL: Select). **CO-C1001U**
Press [SEL] (Select).
- Adjust. **CO-C1121U** **CO-C1101U**
Turn [VOL] **CO-C1001U**
Press [▲] or [▼].

Note: If no operation takes place for more than 5 seconds in the audio menu (2 seconds in Main volume adjustment), the display returns to the regular mode.

Audio menu

VOLUME (Setting Range: 0 to 40, Default: 18)

BASS (Setting Range: -12 dB to +12 dB by 2 dB, Default: 0 dB)

TREBLE (Setting Range: -12 dB to +12 dB by 2 dB, Default: 0 dB)

BALANCE (Setting Range: 15 levels each and 0 (center), Default 0)

FADER (Setting Range: 15 levels each and 0 (center), Default 0)

Note: If the fader is set to front, the pre-amp. output (rear) is decreased.

Troubleshooting

If You Suspect Something Wrong

Check and take steps as described below.

Warning

- Do not use the unit in an irregular condition, for example, without sound, or with smoke or a foul smell, which can cause ignition or electric shock. Immediately stop using the unit and consult your dealer.
- Never try to repair the unit by yourself because it is dangerous to do so.

Trouble	Check point	Trouble	Check point
Common			
No power	Start the engine. (Or turn the ignition switch to the ACC position.)	No sound, or disc is automatically ejected	Load the disc correctly.
	Verify the wiring. (Ex. battery lead, power lead, ground lead, etc.)		Clean the disc.
	Fuse blown (Contact the nearest Panasonic Servicenter.)	Sound skip, poor sound quality	Clean the disc.
Ask a professional for fuse replacement.	Sound skip due to vibration	The maximum permissible tilt angle is 30°.	
Be sure to use the same rated fuse.		Secure the unit.	
No sound	Disable the mute function.	Disc not ejectable	Press [▲]. If the disc is still not ejected, contact the nearest Panasonic Servicenter.
	Verify the wiring.		
Wait until the dew disappears before turning on the unit.	Error Display Messages		
Noise	Make sure that grounding is established properly.	E1	(The disc is ejected automatically.) The disc is dirty, or is upside down. The disc has scratches.
	Adjust the balance and fader.	E2	Check the disc.
Verify the wiring.	Radio	E3	No operation by some cause.
Connect the speaker lead correctly.		If normal operation is not restored, call the store where you purchased the unit or the nearest Servicenter to ask for repairs.	
No sound from left, right, front, or rear speaker	Adjust the balance and fader.	Frequency noise	Tune into another station of high-intensity waves.
	Verify the wiring.		Make sure that the antenna mounted point is grounded properly.
Left and right sounds are reversed	Connect the speaker lead correctly.	Preset data are deleted	The preset memory is cleared to return to the original factory setting when the power connector or battery is disconnected.